

For Guard Fence, Approach Slab, Gutters-
see Roadway Plans

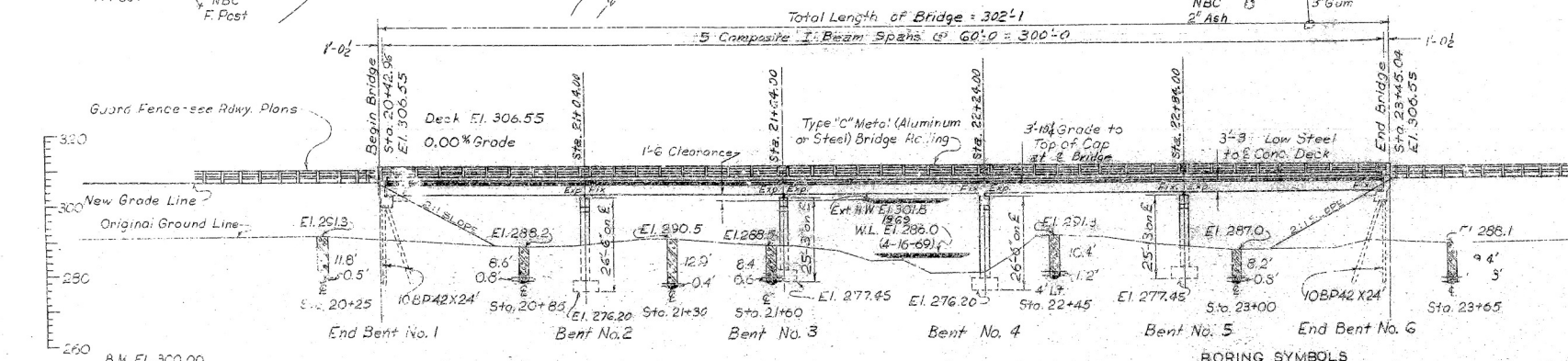
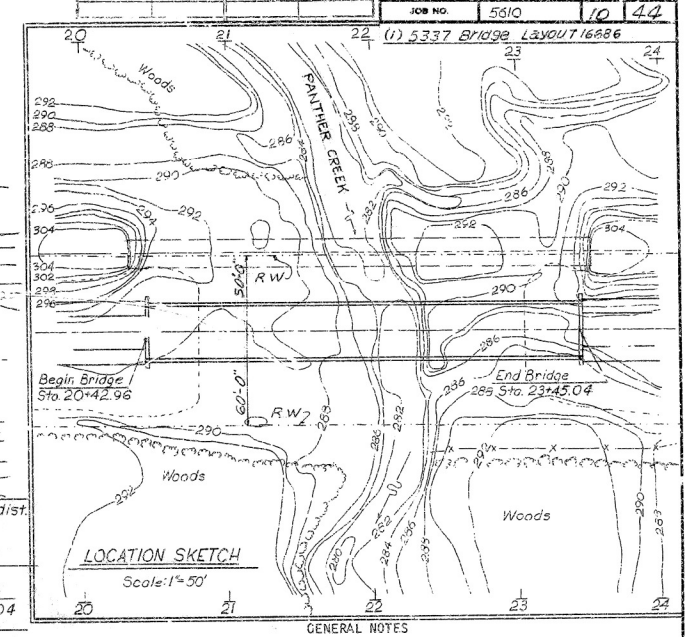
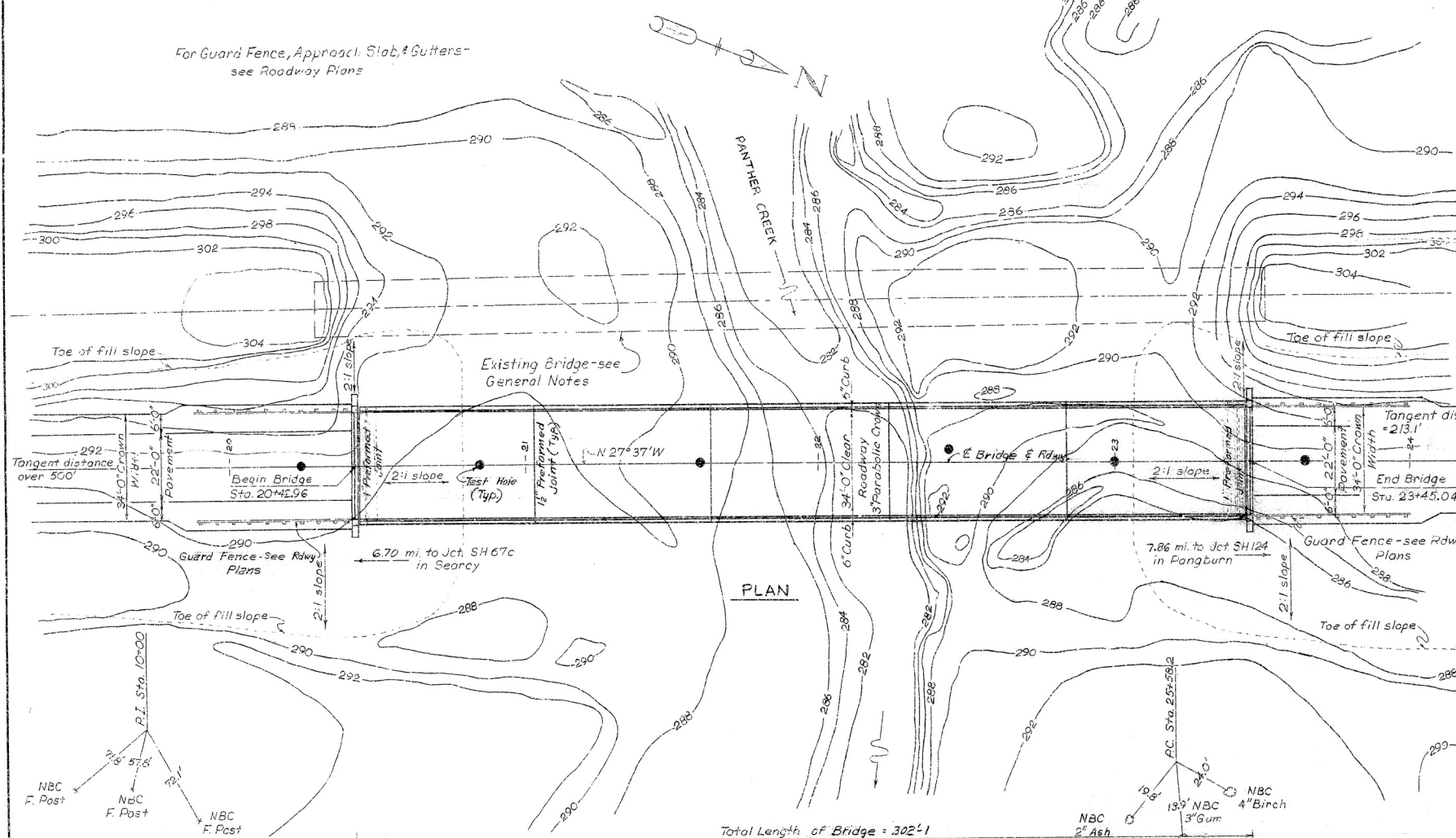

FOUNDATION PRESSURES:
Group I 6.50 ksf
Group II 11.69 ksf

ELEVATION
Drainage Area = 56 sq. mi.
High Water Elevation = 301.8
30 Year Design Discharge = 11,700 cfs

BORING SYMBOLS
Firm sandy clay - few gravel
Very compact gravel - large boulders
Solid rock or large boulder - can't penetrate

FOOTINGS SHALL BE SET A MINIMUM OF 1/4' INTO ROCK. ROCK EXCAVATIONS SHALL BE MADE TO NEAT LINES OF CONCRETE FOOTINGS. CARE SHALL BE EXERCISED TO AVOID SHATTERING OF ROCK FACES BY EXCESSIVE BLASTING. CONCRETE IN FOOTINGS SHALL BE POURED DIRECTLY AGAINST EXCAVATED SURFACES OF ROCK.

ALL CONCRETE SHALL BE POURED IN THE DRY.

ALL PILING SHALL BE 10BP42 AND SHALL BE DRIVEN WITH AN APPROVED AIR STEAM, OR DIESEL HAMMER TO A MINIMUM CAPACITY OF 55 TONS PER PILE AND INTO THE MATERIAL DESIGNATED AS SOLID ROCK ON THE BORING LOGS. LENGTHS OF PILE SHOWN ARE FOR ESTIMATING QUANTITIES ONLY. ORDER LENGTHS SHOWN, CUT-OFF OR BUILD-UP, IF NECESSARY, TO BE PAID FOR IN ACCORDANCE WITH THE STANDARD SPECIFICATIONS. PILES IN END BENTS TO BE DRIVEN AFTER EMBANKMENT TO SUBGRADE IS IN PLACE.

EXISTING BRIDGE NO. 914 BEGINNING APPROXIMATELY 58 FT. LEFT OF STATION 20+30 SHALL BE REMOVED BY THE CONTRACTOR ACCORDING TO SECTION 1006 OF THE SPECIFICATIONS. THE EXISTING BRIDGE CONSISTS OF 12-19 FT. APPROACH SPANS ON TIMBER BENTS AND ONE 90' FT. TRUSS SPAN, 19' H. ROADWAY, FAIR CONDITION. STEEL TRUSS MEMBERS AND GUARD FENCE WILL BE RETAINED BY THE STATE. ALL OTHER MATERIAL BECOMES THE PROPERTY OF THE CONTRACTOR. SEE SP 1006-3.

FOR DETAILS OF END BENTS SEE DWG. NO. 15116.
FOR DETAILS OF INTERMEDIATE BENTS SEE DWG. NO. 16687.
FOR DETAILS OF COMPOSITE I-BEAM SPANS SEE DWG. NOS. 16687A AND 14990D.

DESIGN SPECIFICATIONS: AASHO 1969
LIVE LOADING: H20
UNIT STRESSES: CLASS 5 CONCRETE (f'c)=10 1,200 PSI
REINFORCING STEEL 20,000 PSI
STRUCTURAL STEEL (A-36) 20,000 PSI

**LAYOUT OF
BRIDGE OVER PANTHER CREEK
'BIG CREEK & PANTHER CREEK
BRIDGES & APPR.
WHITE COUNTY**

**ROUTE 16 SEC. 13
ARKANSAS STATE HIGHWAY COMMISSION
LITTLE ROCK, ARK.**

DRAWN BY: EFP DATE: 11-14-69
TRACED BY: DATE: 11-14-69
CHECKED BY: DV DATE: 11-15-69
BRIDGE NO. 5337 DRAWING NO. 16686

Corrected by RNS 9-22-69
BRIDGE ENGINEER